

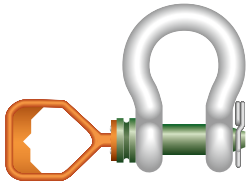

Green Pin® Tapered Pin ROV Shackle D

Release & retrieve ROV shackle (grade 8) with tapered pin and D-handle



P-5361D

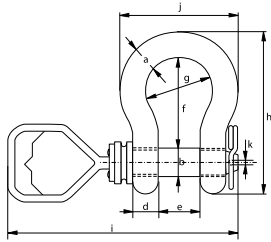

- **Material:** bow and pin alloy steel, grade 8, polar quality, quenched and tempered
- **Safety factor:** MBL equals 5 x WLL
- **Finish:** body painted white, pin painted green
- **Temperature Range:** -60°C up to +200°C
- **Certification:** 2.1 2.2 3.1 MTC^a CE
- **Note:** supplied without wires; design your own wiring plan

working load limit	diameter bow	diameter pin	diameter eye	width eye	width inside	length inside	width bow	length	length bolt	width	diameter clamp	weight each
t	a	b	c	d	e	f	g	h	i	j	k	kg
6.5	22	25	52	22	36	83	58	144	345	102	3.5	1.50
9.5	28	32	66	28	47	108	75	185	381	131	5.5	3.16
12	32	35	72	32	51	115	83	201	393	147	6.5	4.31
17	38	42	88	38	60	146	99	249	417	175	8.5	7.43
25	45	50	103	45	74	178	126	300	464	216	8.5	12.84
35	50	57	111	50	83	197	138	331	484	238	8.5	18.15
42.5	57	65	130	57	95	222	160	377	516	274	7.5	26.29
55	65	70	145	65	105	260	180	433	545	310	7.5	37.60

In inch



working load limit	diameter bow	diameter pin	diameter eye	width eye	width inside	length inside	width bow	length	length bolt	width	diameter clamp	weight each
t	a	b	c	d	e	f	g	h	i	j	k	lbs
6.5	7/8	1	2 1/16	7/8	1 7/16	3 9/32	2 9/32	5 21/32	13 19/32	4 1/32	1/8	3.31
9.5	1 1/8	1 1/4	2 19/32	1 1/8	1 7/8	4 1/4	2 15/16	7 9/32	15	5 5/32	7/32	6.97
12	1 1/4	1 3/8	2 27/32	1 9/32	2	4 17/32	3 9/32	7 29/32	15 15/32	5 25/32	1/4	9.49
17	1 1/2	1 5/8	3 15/32	1 17/32	2 11/32	5 3/4	3 29/32	9 13/16	16 13/32	6 7/8	11/32	16.37
25	1 3/4	2	4 1/16	1 25/32	2 29/32	7	4 15/16	11 13/16	18 9/32	8 1/2	11/32	28.31
35	2	2 1/4	4 3/8	1 31/32	3 9/32	7 3/4	5 7/16	13 1/32	19 1/16	9 3/8	11/32	40.01
42.5	2 1/4	2 9/16	5 1/8	2 1/4	3 3/4	8 3/4	6 9/32	14 27/32	20 5/16	10 25/32	9/32	57.96
55	2 1/2	2 3/4	5 23/32	2 9/16	4 1/8	10 1/4	7 9/32	17 1/16	21 15/32	12 7/32	9/32	82.89

INFO